

d
1627/131

1627/854

1627/855

3316/194

3316/189

3316/184

76/1

76/3

3316/185

3316/186

3316/187

3316/100

238/7

3235/27

3237/1

3235/3

75/1

18 17
-3.07-
-1.82-
-3.18-

-19.34-

-21.27-

15 -8.04-

14

-16.14-

-16.36-

13

-4.75-

-0.67-
-3.50-

12

-15.80-

11

-22.1-

19

-42.55-

20

-18.19-

21

-24.65-

-33.64-

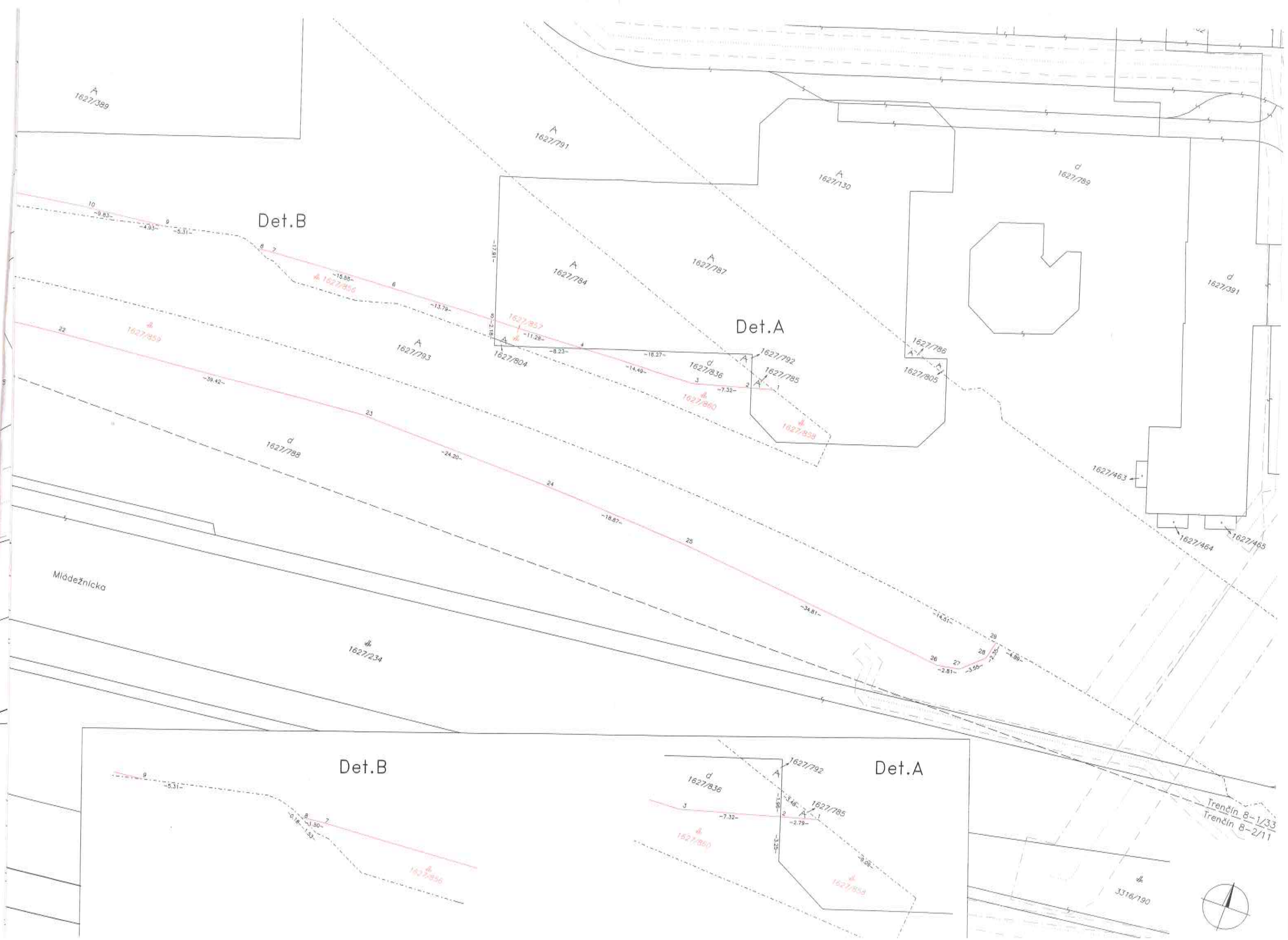

Trenčín 8-1/33
Trenčín 8-2/11

3316/190